



FFM-10/FFM-20 系列 Series

【特点与功能】

Specifications and Functions

- 体积小巧
Small size
- O圈密封，便于快速安装
O ring seal for quick installation
- 自带过滤装置，防止堵塞
Equipped with filter device to prevent clogging
- 温度特性好，漏率稳定
Excellent temperature characteristics and stable leakage rate

该标准漏孔体积小，可直接嵌入真实产品，制作真实的标准泄漏工件。避免了由于采用模拟泄漏件造成的与实际工况不符的问题，大大提高了检测的可靠性。

This leak standard is smaller in size and can be directly embedded into the real tested product, it is the real product with standard leakage. The different working condition problem caused by the use of simulated leakage parts is solved, and the reliability of test is greatly improved.

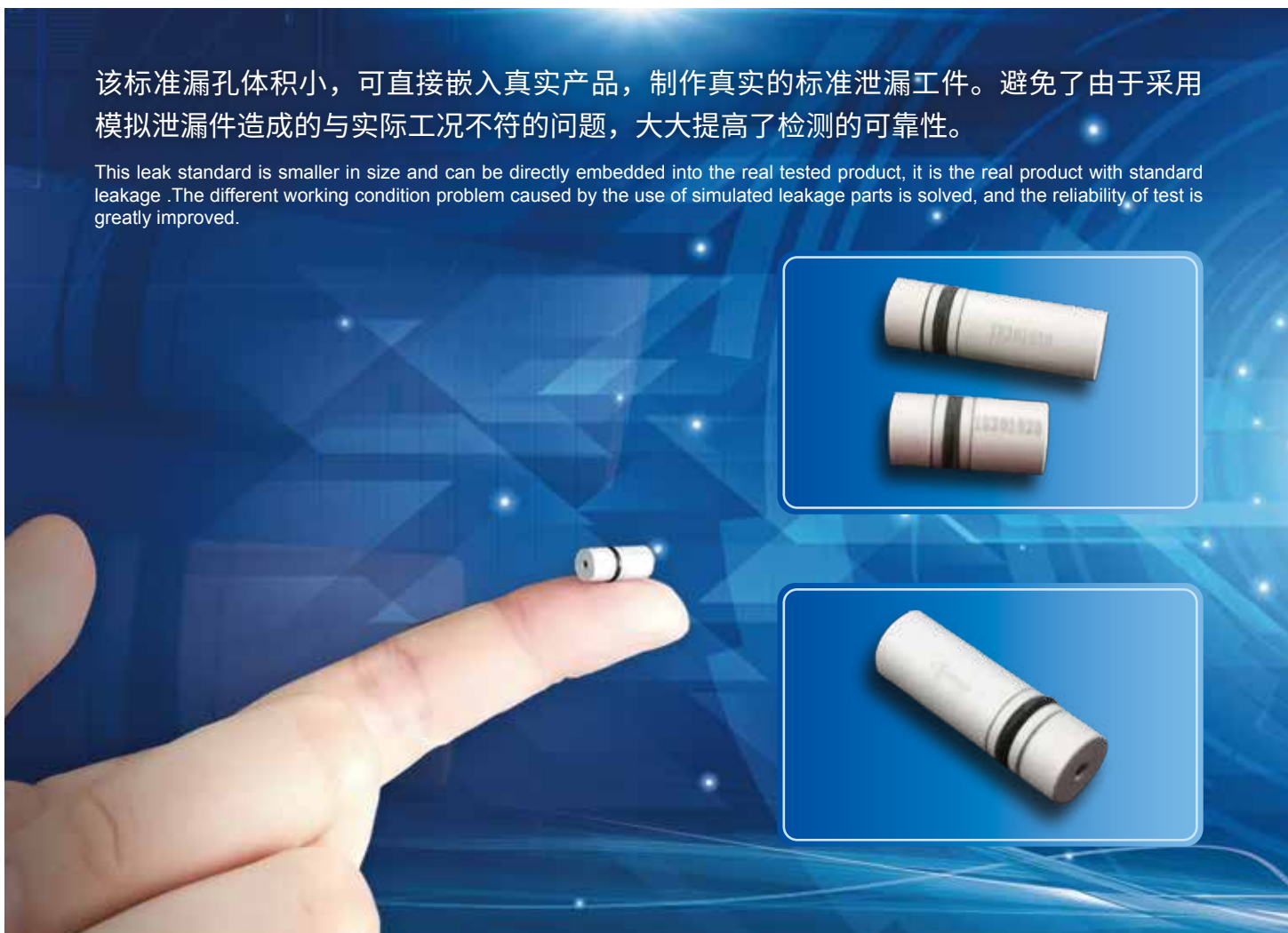

规格 Specifications

型号 Model	FFM-10	FFM-20
介质 Media	空气或无腐蚀性气体 Air or non-corrosive gas	
压力范围 Pressure Range	-80~800kPa	-100~1000kPa
漏率范围 Leak Rate Range	0.5 mL/min~320mL/min (详见附表1) See appendix table 1	10 ⁻⁸ Pa.m ³ /s~10 ⁻⁴ Pa.m ³ /s (详见附表2) See appendix table 2
制作偏差 Manufacturing Deviation	±5%F.S.	0.5个数量级 0.5Magnitude

FFM-10漏率范围 (附表1)
FFM-10 Leak Rate Range (appendix table 1)

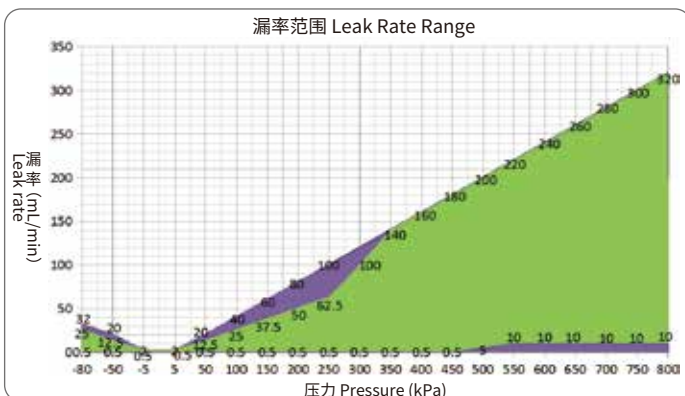

FFM-20漏率范围 (附表2)

FFM-20 Leak Rate Range (appendix table 2)

一次侧压力kPa(G) Primary Side Pressure	二次侧压力kPa(G) Secondary Side Pressure	10 ⁻⁸ 量级 10 ⁻⁸ Magnitude	10 ⁻⁷ 量级 10 ⁻⁷ Magnitude	10 ⁻⁶ 量级 10 ⁻⁶ Magnitude	10 ⁻⁵ 量级 10 ⁻⁵ Magnitude	10 ⁻⁴ 量级 10 ⁻⁴ Magnitude
0	-100					
100	0					
200	0	-				
300	0	-				
400	0	-				
500	0	-				
600	0	-				
700	0	-				
800	0	-				
900	0	-				
1000	0	-				

备注：如有其它技术要求，请与我公司联系。 Please contact us if you have any technical requirements.

外形尺寸 Outline dimensions

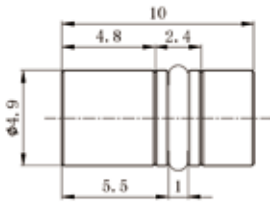

FFM-10

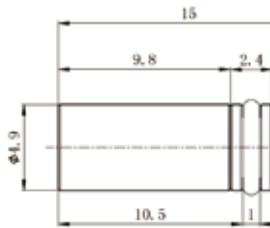

FFM-20

应用举例 Application examples

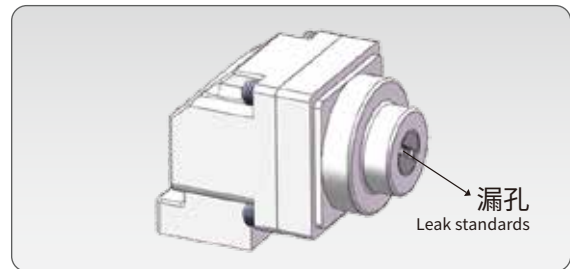
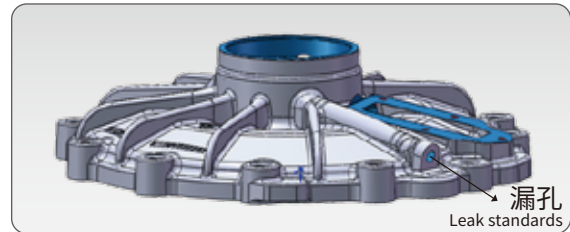

主要产品 ● 气密检漏仪 ● 数字压力表 ● 流量计 ● 自动压力、流量控制器 ● 密封性能检测专用设备

BOYI | 天津博益气动股份有限公司
TIANJIN BOYI PNEUMATICS CO., LTD



代理商

公司·工厂：天津经济技术开发区第九大街80号丰华工业园7号厂区 邮编：300457
 电话：(86)22-59810966 传真：(86)22-59810963
 北京营销中心：北京市丰台区角门18号名流未来大厦801-805室 邮编：100068
 电话：(86)10-87582461 传真：(86)10-87582462
 网址：www.boyiqd.com 邮箱：sales@boyiqd.com



扫一扫，查看
办事处地址

公司在广州、顺德、福州、台州、宁波、杭州、重庆、武汉、上海、苏州、西安、沈阳设有分支机构。